

ARCHITRAVE DETAIL 1 - 5mm

ARCHITRAVE DETAIL 2 - 12mm

SKIRTING TYPES

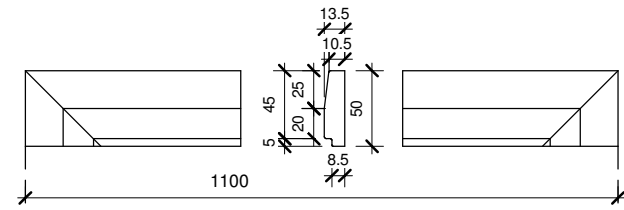

ARCHITRAVE
SA-16 - 5
(1100mm length)

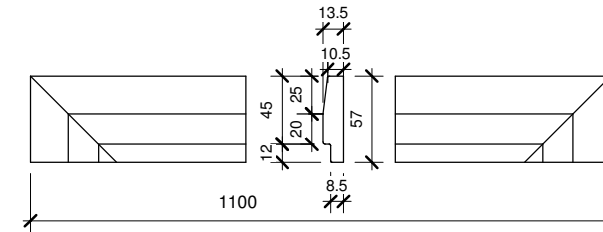

ARCHITRAVE
SA-16 - 12
(1100mm length)

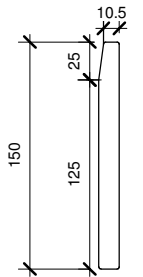

SKIRTING SA-14
SA-14 (150)
(3000mm length)

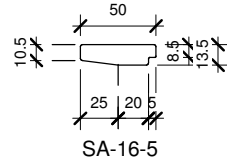

SA-16-5

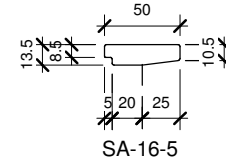

SA-16-12

VERTICAL PROFILE
SA-16 - 12-V
(3000mm length)

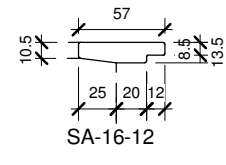

SA-16-5

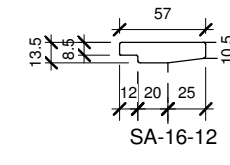

SA-16-12

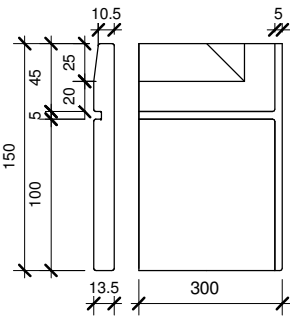

SA-14 (150/5x5)L
(300mm length)

SKIRTING TRANSITIONS
SA-14-5mm L AND SA-14-5mm R

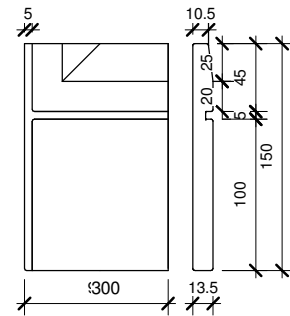

SA-14 (150/5x5)R
(300mm length)

SKIRTING SA-14-5mm
SA-14 (150/5x5)
(3000mm length)

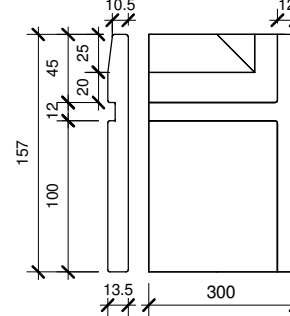

SA-14 (157/12x12)L
(300mm length)

SKIRTING TRANSITIONS
SA-14-12mm L AND SA-14-12mm R

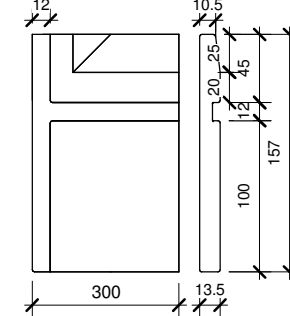

SA-14 (157/12x12)R
(300mm length)

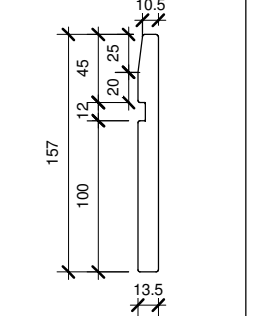

SKIRTING SA-14-12mm
SA-14 (157/12x12)
(3000mm length)

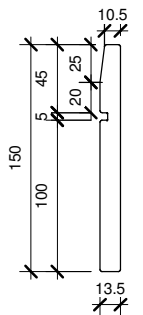

SKIRTING SA-14-5mm
SA-14 (150/5x5)
(3000mm length)

ARCHITRAVE DETAIL 3 - 40mm

ARCHITRAVE DETAIL 4

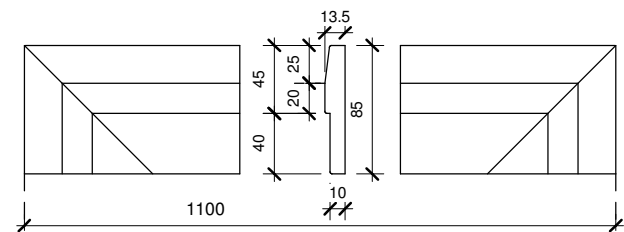

ARCHITRAVE
SA-16 - 40
(1100mm length)

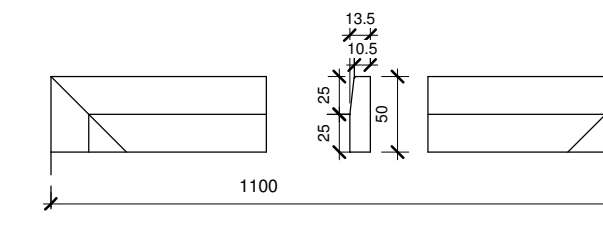

ARCHITRAVE
SA-16
(1100mm length)

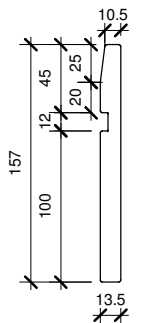

SKIRTING SA-14-12mm
SA-14 (157/12x12)
(3000mm length)

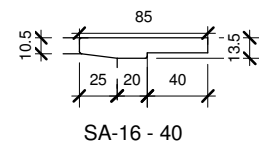

SA-16-40

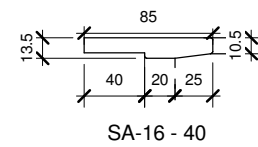

SA-16

VERTICAL PROFILE
SA-16
(3000mm length)

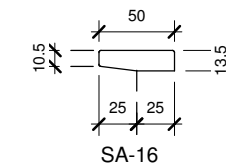

SA-16-40

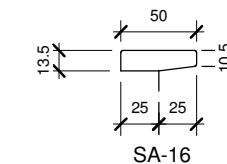

SA-16

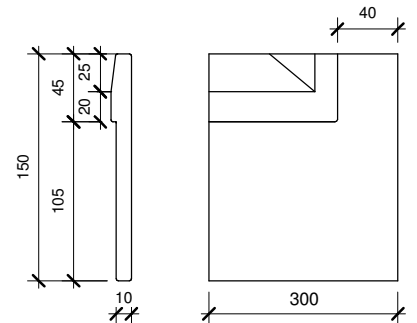

SA-15 (150/40x40)L
(300mm length)

SKIRTING TRANSITIONS
SA-15-40mm L AND SA-15-40mm R

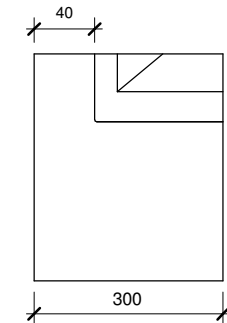

SA-15 (150/40x40)R
(300mm length)

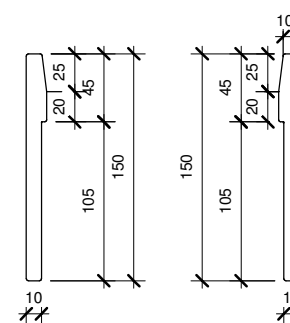

SKIRTING SA-15-40mm
SA-15 (150/40x40)
(3000mm length)

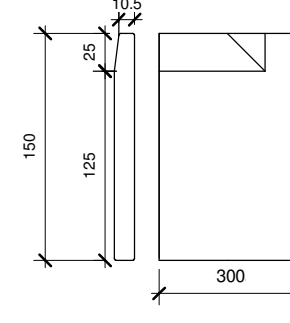

SA-14 (150/5x5)L
(300mm length)

SKIRTING TRANSITIONS
SA-14 L AND SA-14 R

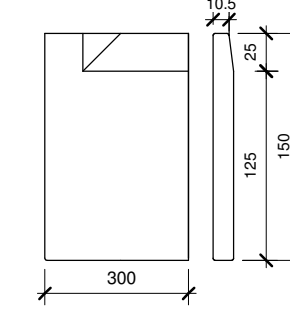

SA-14 (150/5x5)R
(300mm length)

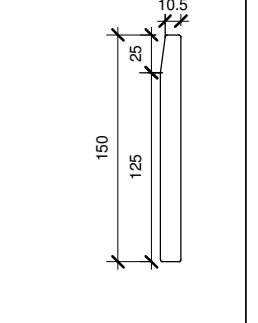

SKIRTING SA-14
SA-14 (150/5x5)
(3000mm length)

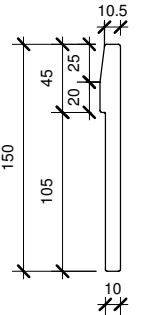

SKIRTING SA-15-40mm
SA-15 (150/40x40)
(3000mm length)



Seamless Abutment Solutions Ltd
Solutions House
16 Bellrope Meadow
Sampford Road
Thaxted, Essex CM6 2FE
ENGLAND

Tel: +44 1371 832 152
Fax: +44 1371 831 983
E-mail: info@seamlessabutments.com

Copyright: Copyright and design is owned by SA Solutions Ltd.
Patent: Intellectual rights are owned by SA Solutions Ltd.
UK Patent No: 2429022.

Date: 08-01-2013
Drawn by: DF

Title: SA- Drywall range - architrave details and skirting types.
Drawing No: SA- Drywall range - architrave details and skirting types.